

INSTALLATION & OPERATION MANUAL

ECO PREMIUM POWER SELECTABLE Highbay Luminaire





Για οδηγίες τοποθέτησης παρακαλούμε επισκεφθείτε την ιστοσελίδα μας στο www.elmasco.eu

BEFORE YOU BEGIN

Read these instructions carefully



WARNING	
<ul style="list-style-type: none"> All electrical connections must be in accordance with the local code, ordinance, or the National electrical code. If you are unfamiliar with methods of installing electrical wiring, secure the services of the qualified licensed electrician. 	
<p>RISK OF ELECTRIC SHOCK</p> <ul style="list-style-type: none"> Turn power off before installation, removal or inspection Ensure that luminaire conductive parts are properly grounded 	
<p>ELECTRICAL REQUIREMENTS</p> <ul style="list-style-type: none"> The luminaire must be supplied with 220-240 VAC, 50/60 Hz, and connected to a properly grounded circuit. 	
<p>SAVE THESE INSTRUCTIONS</p> <ul style="list-style-type: none"> Use these instructions only in the manner intended by the manufacturer. Keep these instructions for future maintenance work. If you have any questions, contact the manufacturer. 	

MODELS COVERED BY THESE INSTALLATION INSTRUCTIONS

Model no.	CYFELCO 2 UHB 080W 840 PS	CYFELCO 2 UHB 080W 865 PS	CYFELCO 2 UHB 100W 840 PS	CYFELCO 2 UHB 100W 865 PS	CYFELCO 2 UHB 150W 840 PS	CYFELCO 2 UHB 150W 865 PS
Code	952-120	952-121	952-122	952-123	952-124	952-125
Rated Voltage	220/240V					
Frequency	50/60Hz					
Rated Power	100W	100W	150W	150W	200W	200W
Protection class	I					
IP Protection	IP65					
IK Rating	IK08					

ACCESSORIES

Product Code	Product Description
952-126	CYFELCO UHB-PS BRACKET
952-127	CYFELCO UHB-PS SAFETY CHAIN
952-128	CYFELCO UHB-PS AL REFLECTOR 100W

Product Code	Product Description
952-129	CYFELCO UHB-PS PC REFLECTOR 100W
952-130	CYFELCO UHB-PS AL REFLECTOR 150/200W
952-131	CYFELCO UHB-PS PC REFLECTOR 150/200W

INSTALLATION MANUAL



PREPARATION

Carefully unpack unit from its packaging. Inspect from defects before installing.
Take all necessary measures to prevent any contamination of the luminaire from water, oil or dirt.

INSTALLATION

Must be carried out from a licenced certified electrician

Ceiling Suspended Installation Procedure

1. Remove highbay luminaire from packaging and place upright
2. Rotate the suspension hook until it is fixed on the highbay light and screw in the security bolt for safety.
3. Hang the luminaire directly with the snap hook in the right place.

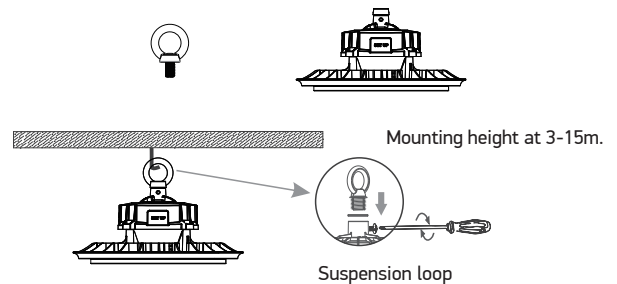

4. Make connection with power supply and light up.

Standard Cable Config:
1. 0.3m VDE/UL listed rubber cable
2. Diameter of 3x1.0mm
3. With line label

Brown: L
Blue: N
Yellow and green ⊕

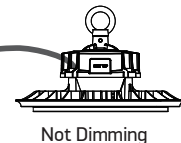

Power Selection

IMPORTANT !!

Power selections MUST NOT be changed whilst product is energised.

	Power	Power	Power
LOW	60W	90W	110W
MID	80W	120W	150W
HIGH	100W	150W	200W

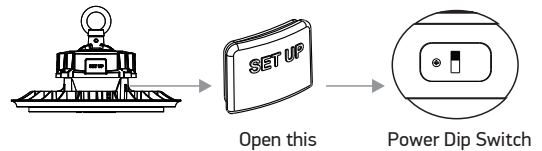

Beam Angle Adjustment

1. Remove the lens by turning the screw
2. Align the angle mark on the lens with the triangle mark on the light board.
3. Install the screws.

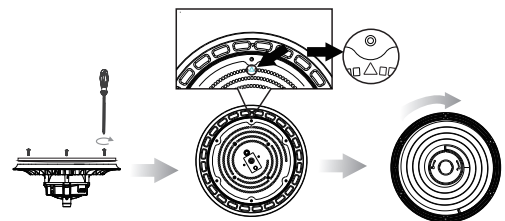

Reflector Installation

Reflector option and replacement:

1. Match 4pcs screw holes between reflector and veil
2. Screw out 4pcs screws of the veil at right place
3. Put the reflector onto the luminaries and make sure all screw holes matched again.
4. Fix the reflector with extra screws and fitting

